

Parking Staging

67

Parking Check-in

Main Tunnel

Road America Center

Turn 5 UR

Turn 14 Unreserved

Lester Garage

North Paddock

Gearbox

Competition Paddock

Main Paved & Garages

West Paved Paddock

West Paddock

Sargento Bridge

Upper Paved Paddock

South Unreserved Paddock

Tire Companies

South Unreserved Paddock

Briggs Tunnel

# June Sprints Parking

# Turn 14 (Reserved)

From Gate 6 Tunnel

Emergency Access

↓  
To False Grid

Not a space

Not a space

#05-06

#07-08

#09-10

#11 Not a space when Lester CP is used

#12 Not a space when Lester CP is used

#13

#14

#15-16

#17-18

#19-20

#21-22

# NORTH PADDOCK (RESERVED)

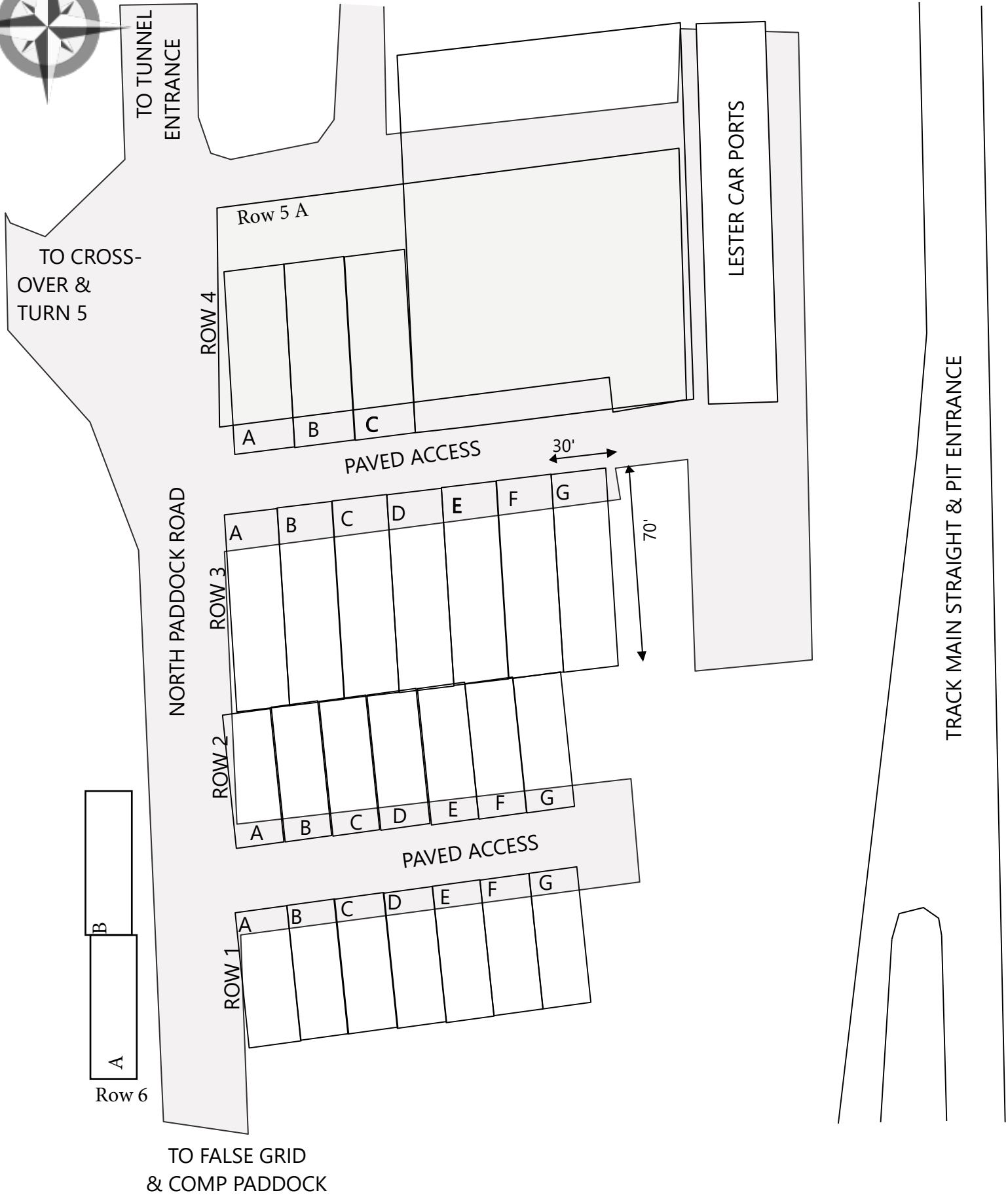

# Turn 5 (Unreserved)

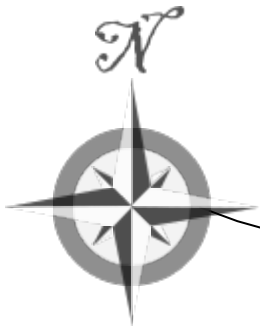

RA  
Center

Worker  
Parking

Worker  
Parking

Turn 5

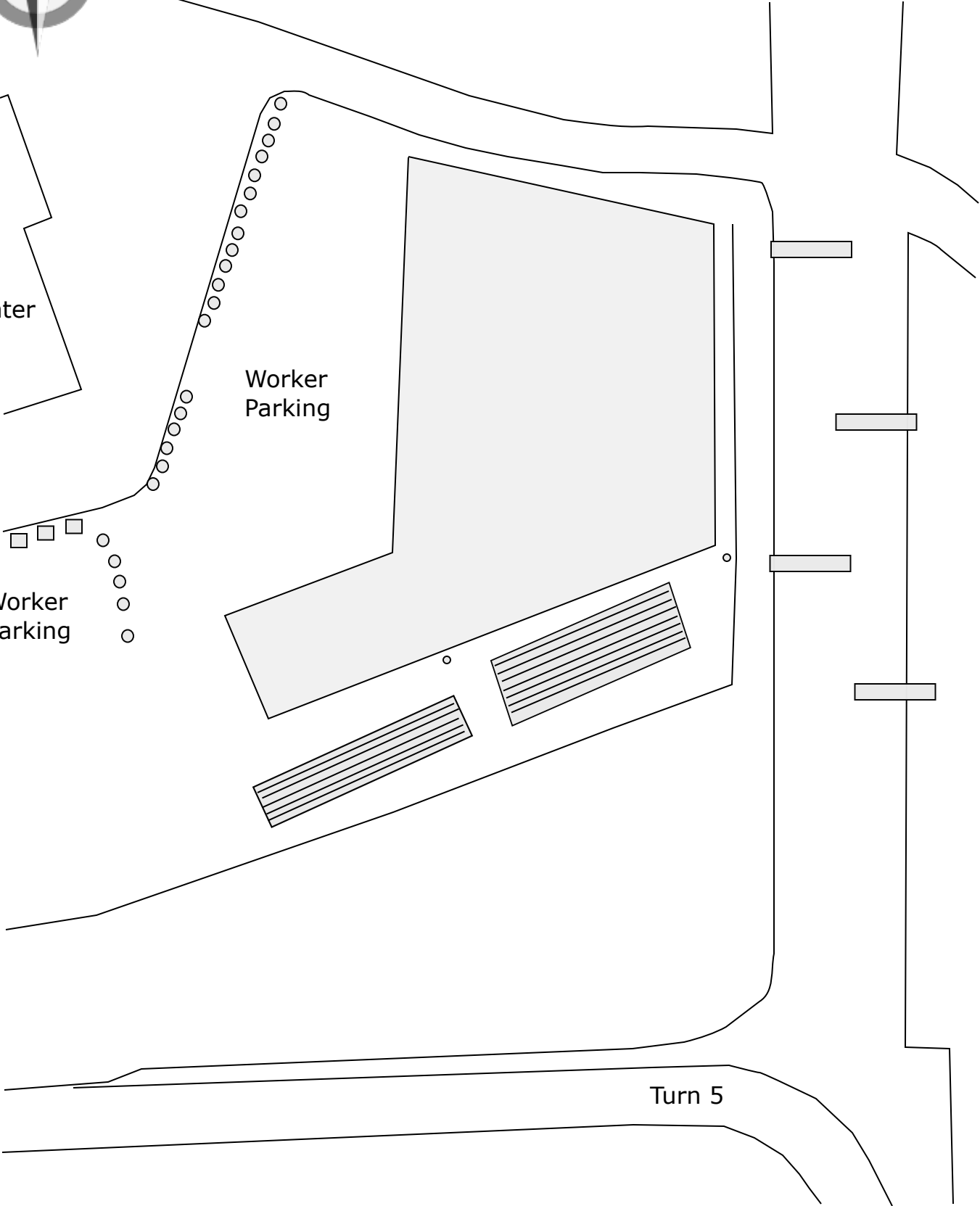

# COMPETITION Paddock - ROWS 7-13

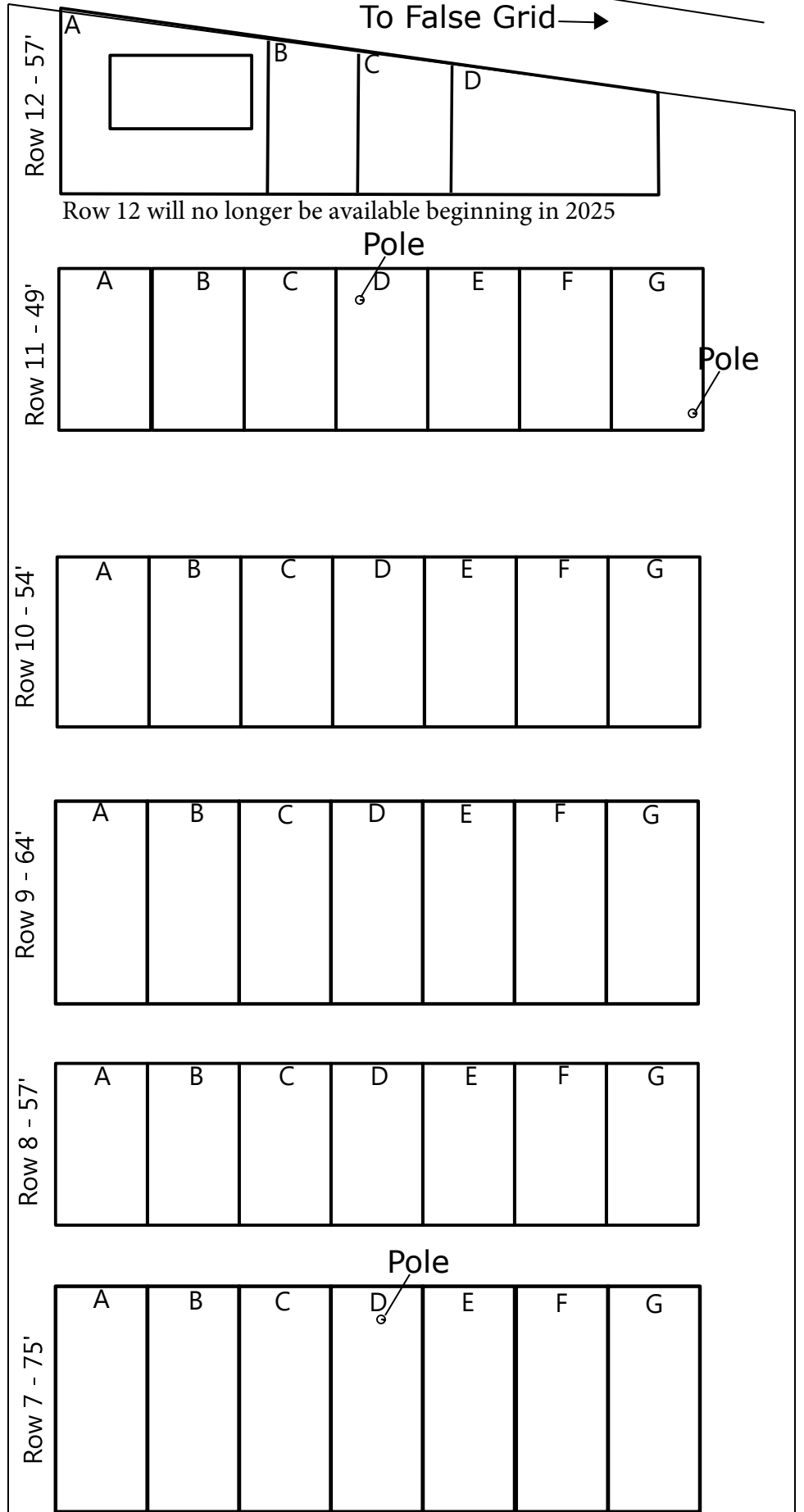
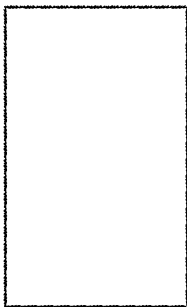
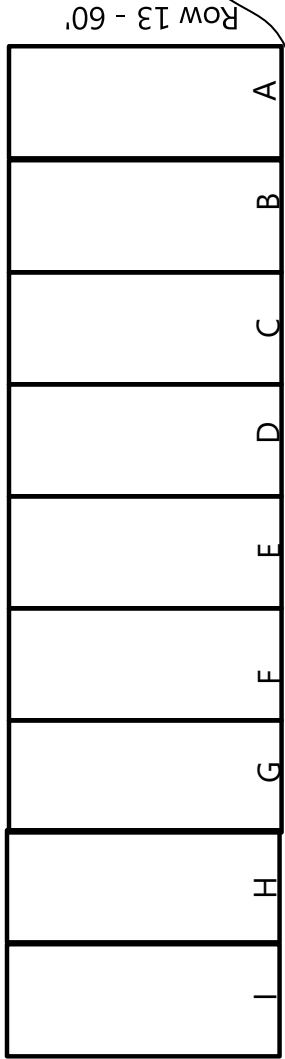

# COMPETITION PADDOCK ROWS 1-6

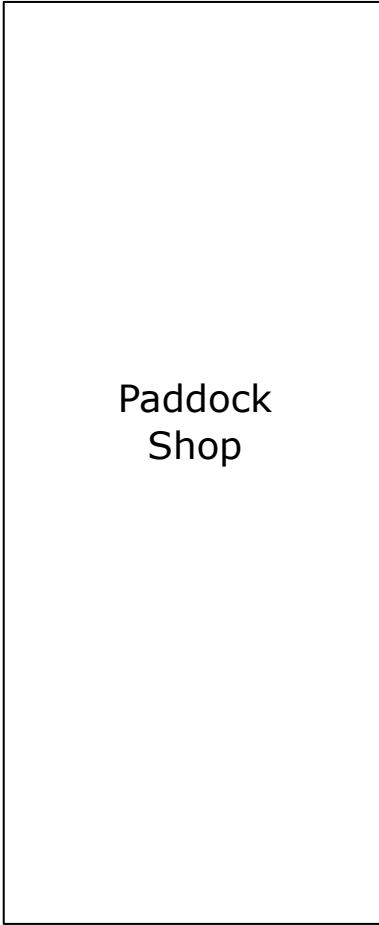

To Lower West & South Paddock

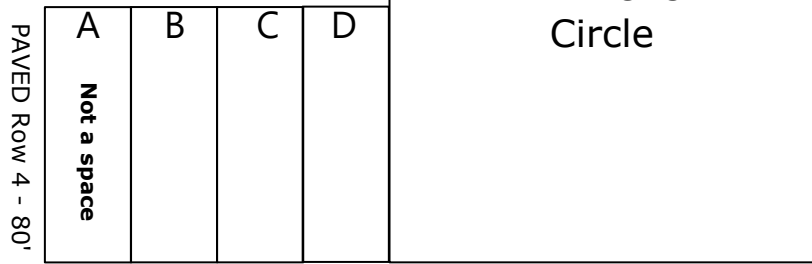
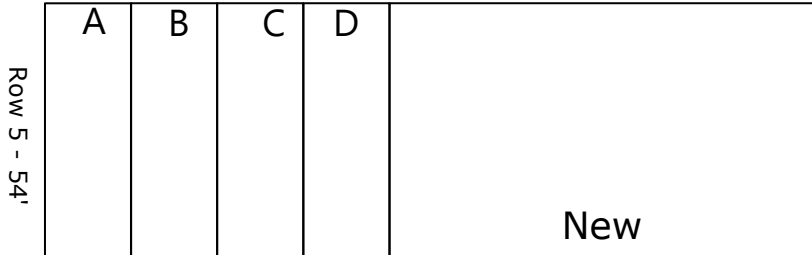
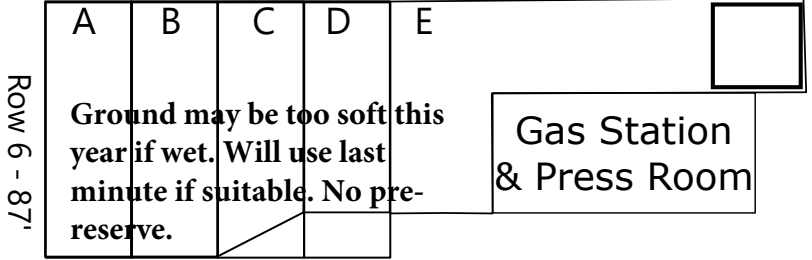
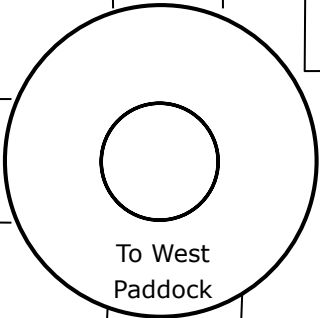

To Main Paddock

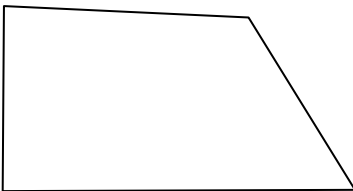
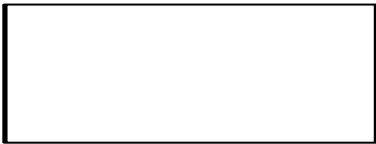

Paker John's BBQ

# MAIN PAVED NORTH END

To Tunnel

Medical

Restrooms /  
Showers

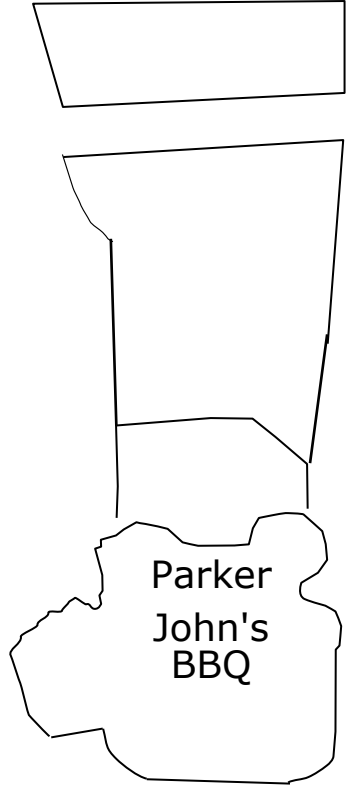
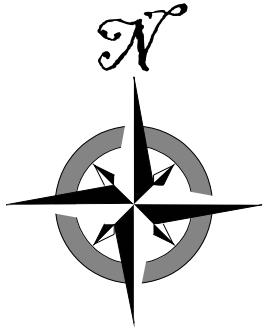

West  
Paved  
Paddock

# 1	
# 2	
# 3	
# 4	
# 5	
# 6	
# 7	
# 8	
# 9	
# 10	
# 11	
# 12	
# 13	
# 14	
# 15	
# 16	
# 17	
# 18	
# 19	
# 20	
# 21	
# 22	
# 23	
# 24	
# 25	

Drive

# MAIN PAVED PADDOCK - SOUTH END

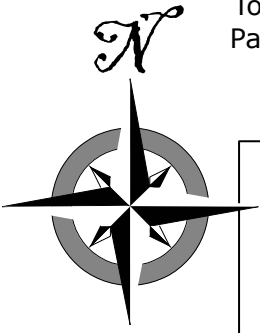

To West Paddock

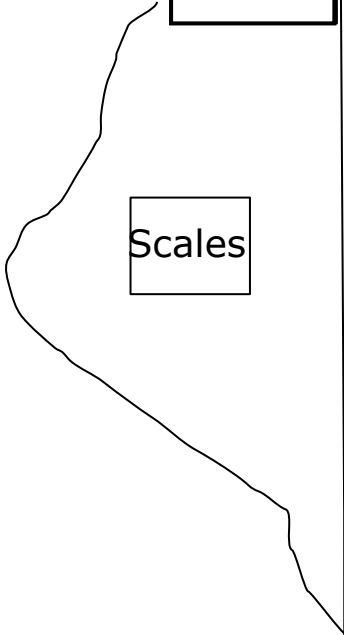

Scales

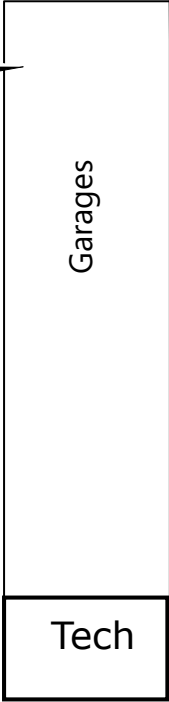

Garages

Tech

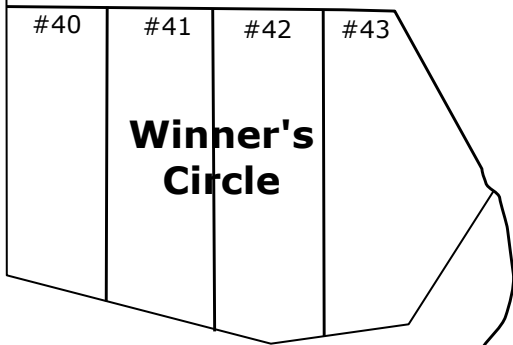
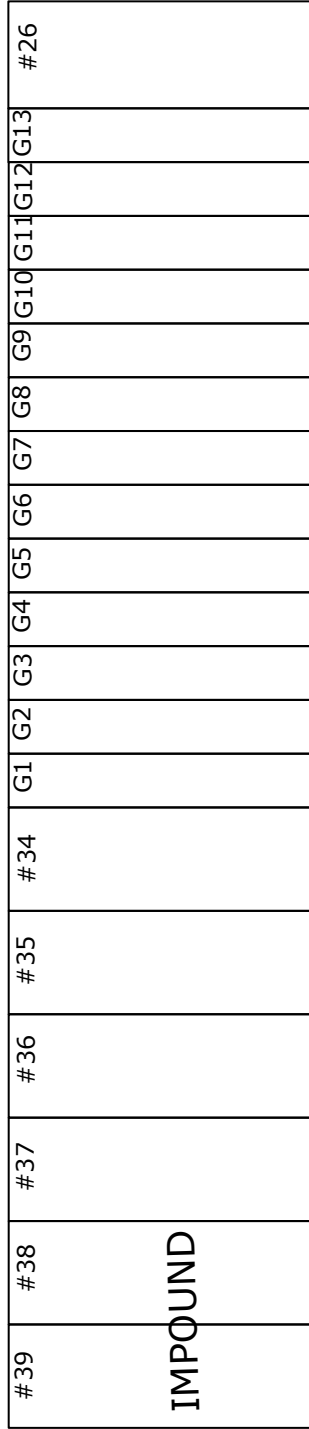

To Upper Paved

Pit Lane

Main Straight

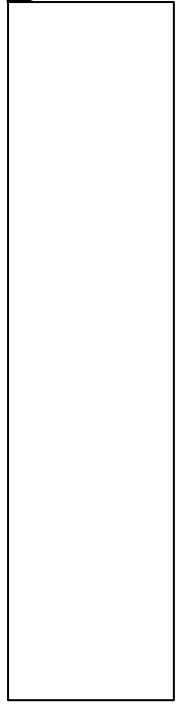



# West Paved (Reserved)



Medical

West

To South Paddock & Sargento Bridge

#86	#85	#84	#83	#82	#81	#80
-----	-----	-----	-----	-----	-----	-----

#70	#71	#72	#73	#74	#75	#76	#77	#78	#79
-----	-----	-----	-----	-----	-----	-----	-----	-----	-----

#69	#68	#67	#66	#65	#64	#63	#62	#61	#60	#59	#58
-----	-----	-----	-----	-----	-----	-----	-----	-----	-----	-----	-----

Parker John's  
BBQ & Wings

#46*	#47*	#48	#49	#50	#51	#52	#53	#54	#55	#56	#57
------	------	-----	-----	-----	-----	-----	-----	-----	-----	-----	-----

#45\*

# West Paddock (Reserved)



Medical

No tow rigs within first 10' from road  
#1 #2 #3 #4 #5 #6  
To South Paddock & Sargento Bridge

No tow rigs within first 10' from road  
#7 #8 #9 #10 #11 #12 #13

West  
Paved

# UPPER PAVED PADDOCK



Tire Companies

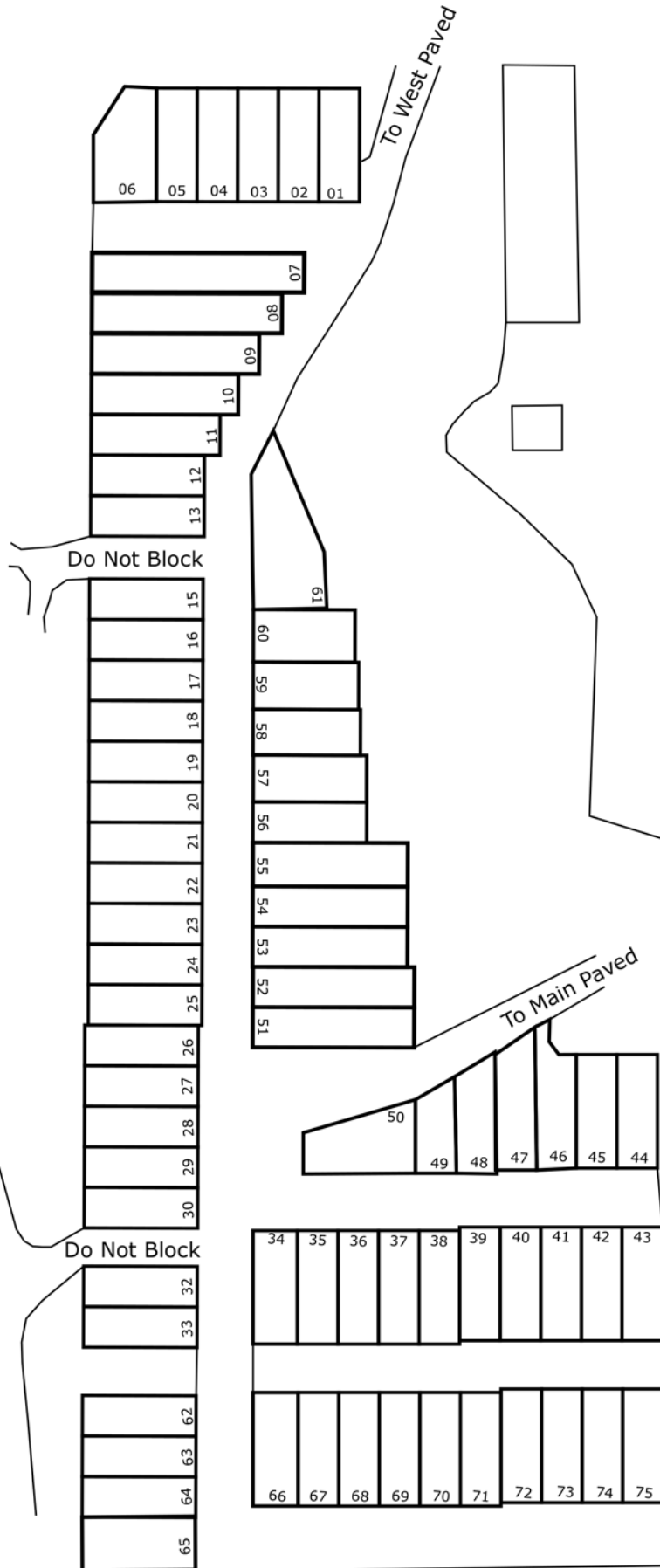

# UPPER PAVED PADDOCK (North)

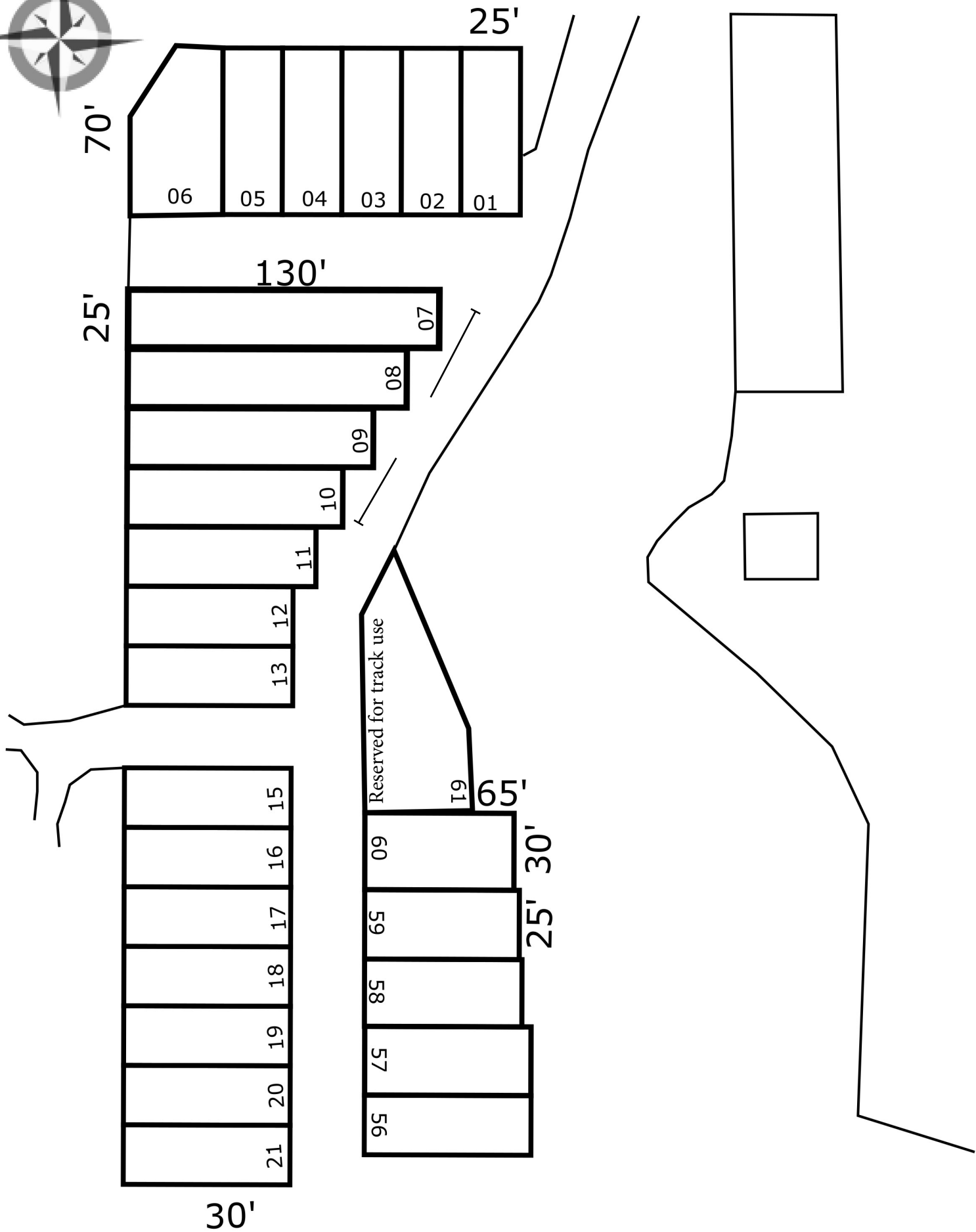

# UPPER PAVED PADDOCK (South)

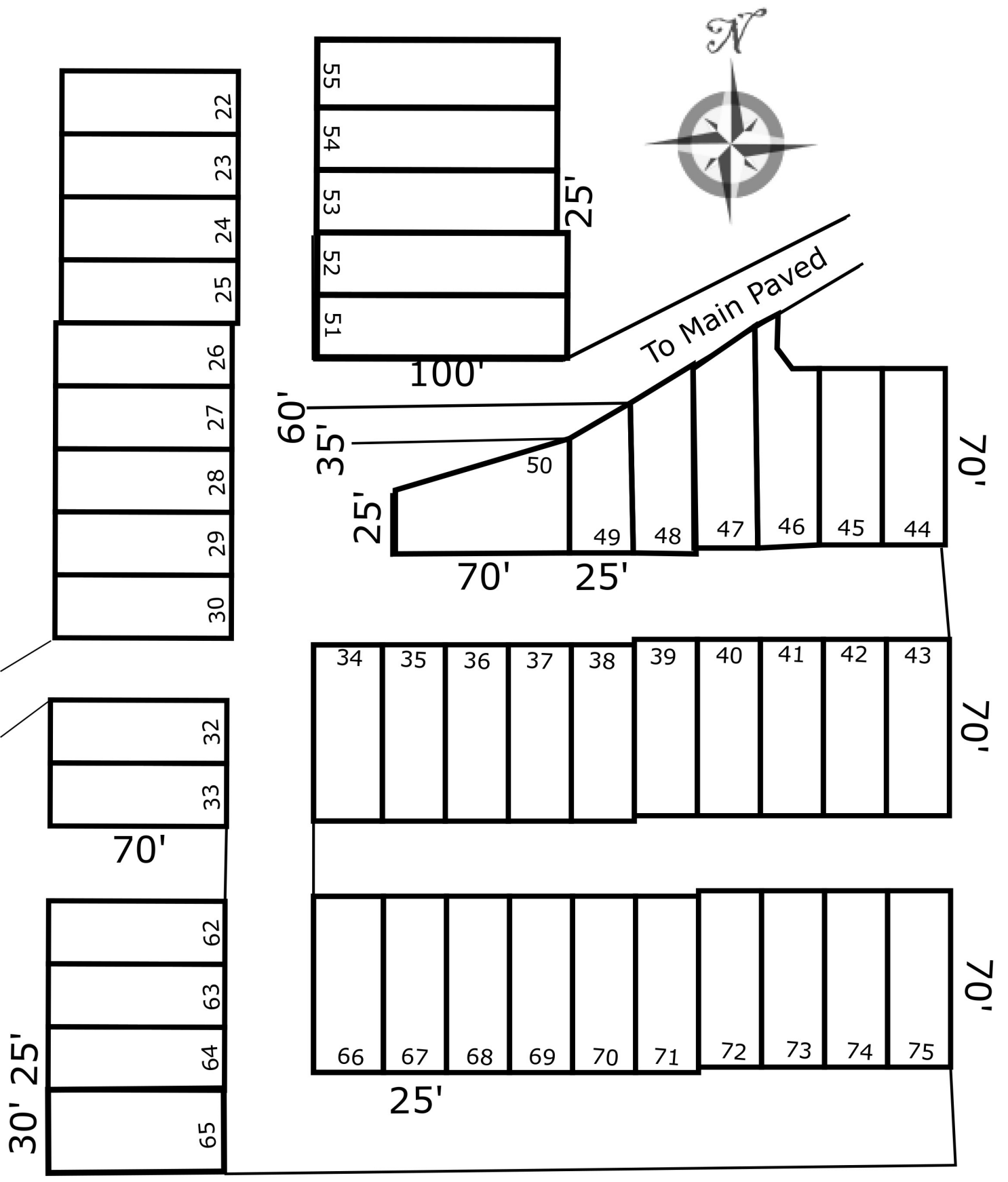

# South (Unreserved)

