

June Sprints Parking

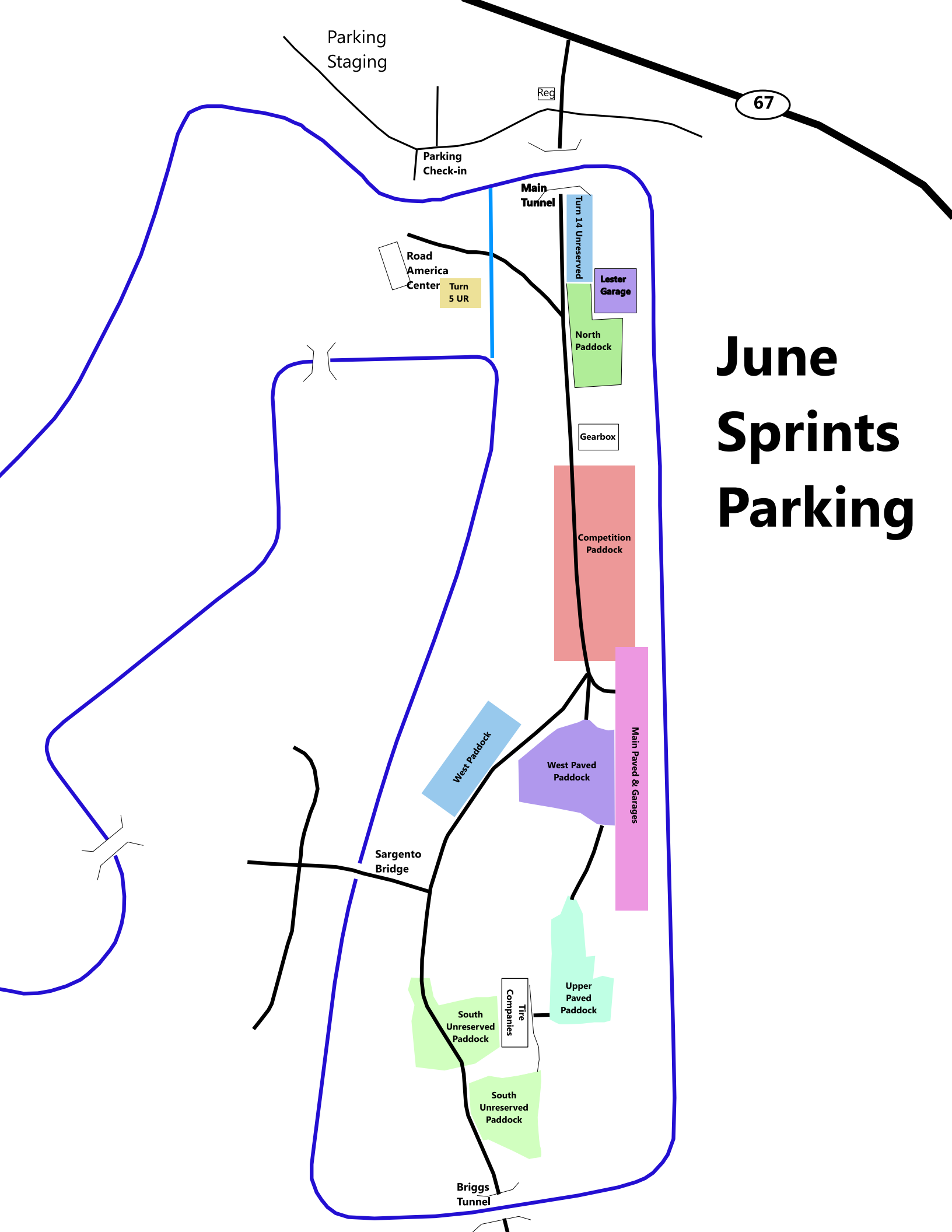

Turn 14 (Reserved)

From Gate 6 Tunnel

Emergency Access

↓
To False Grid

Not a space

Not a space

#05-06

#07-08

#09-10

#11 Not a space when Lester CP is used

#12 Not a space when Lester CP is used

#13

#14

#15-16

#17-18

#19-20

#21-22

NORTH PADDOCK (RESERVED)

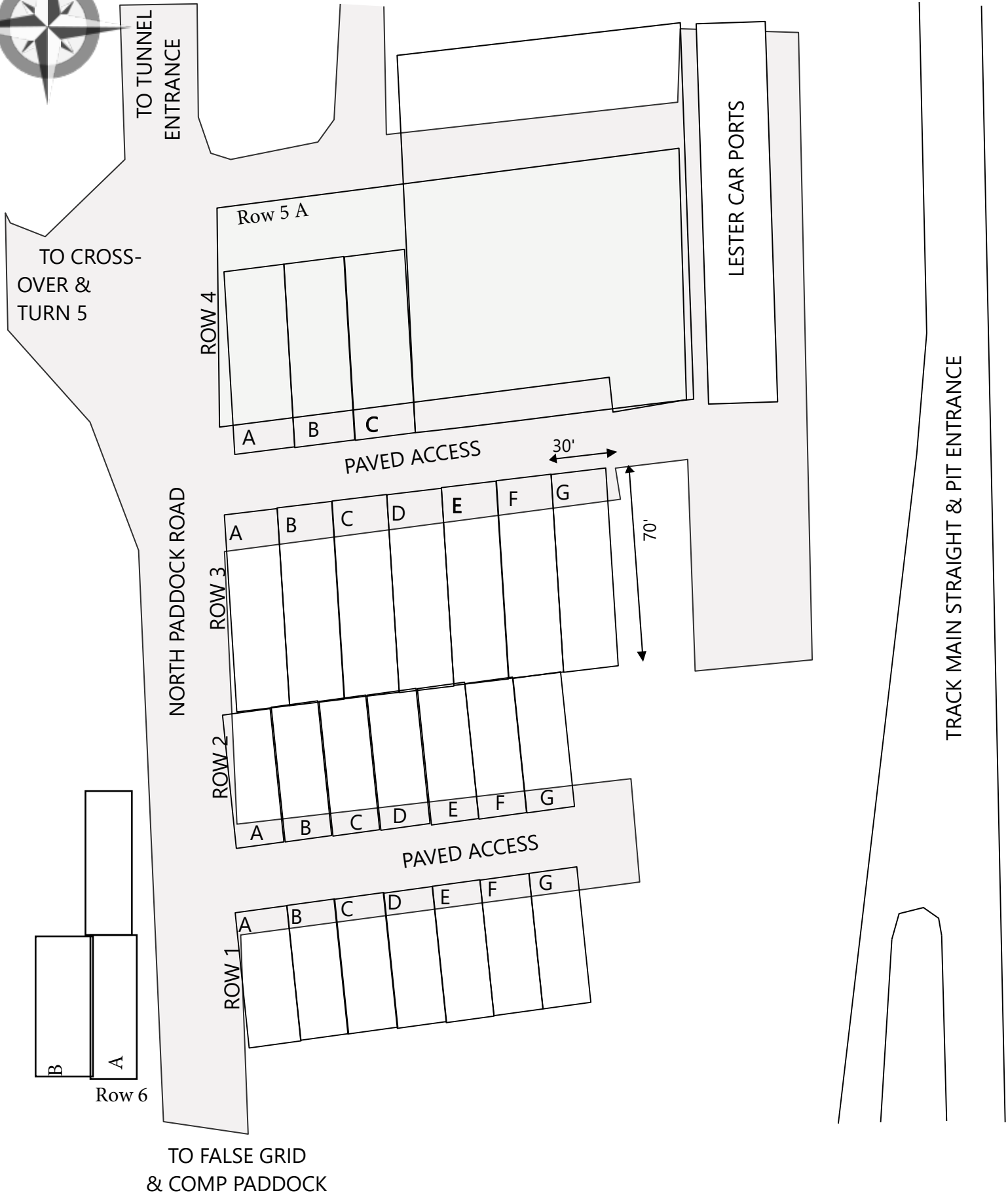



PAD (Paved)

Large spots are 30' x 100' (approx.)
Small spots are 30' x 60' (approx.)

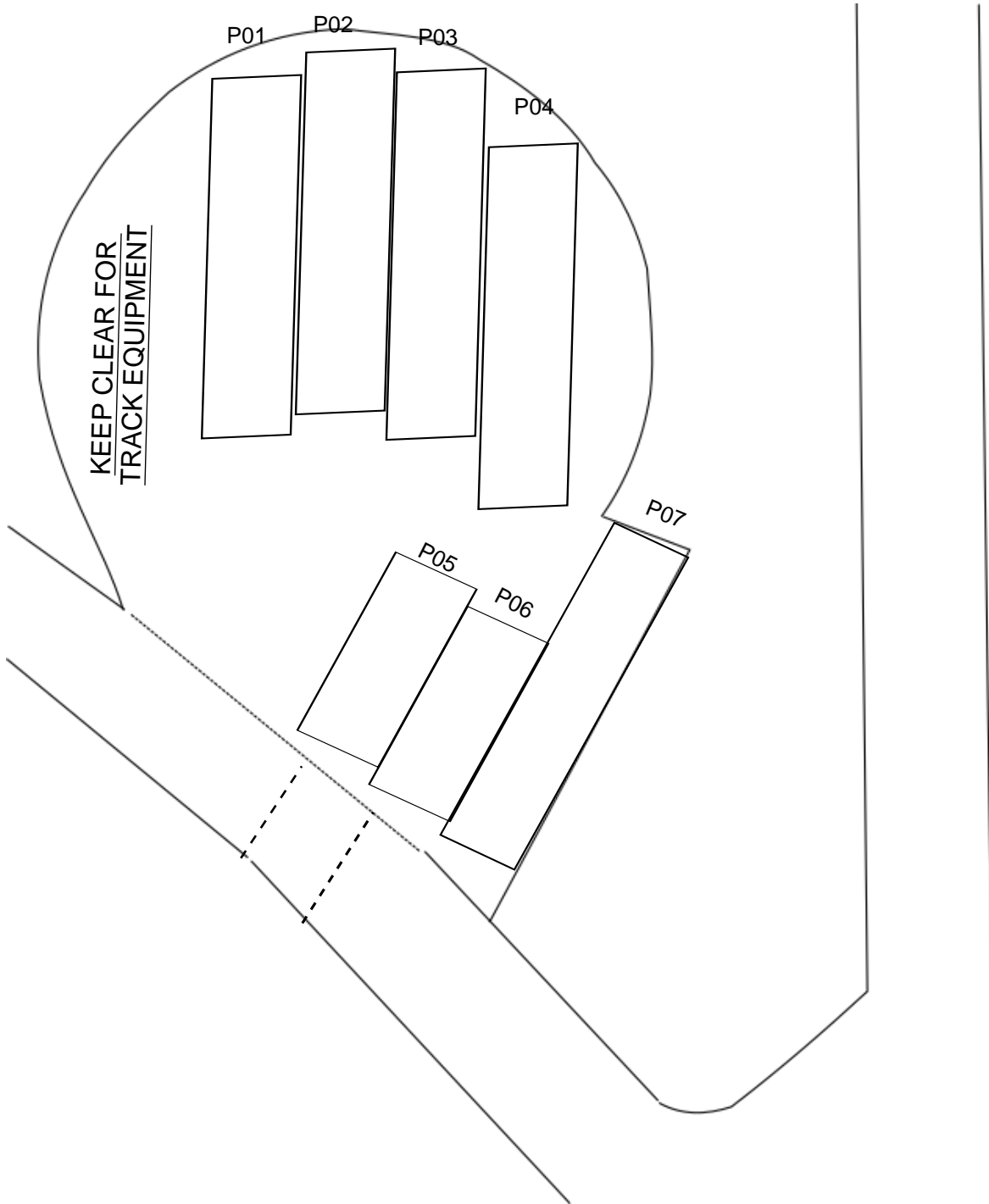

Turn 5 (Unreserved)

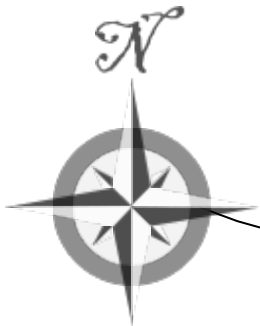

RA
Center

Worker
Parking

Worker
Parking

Turn 5

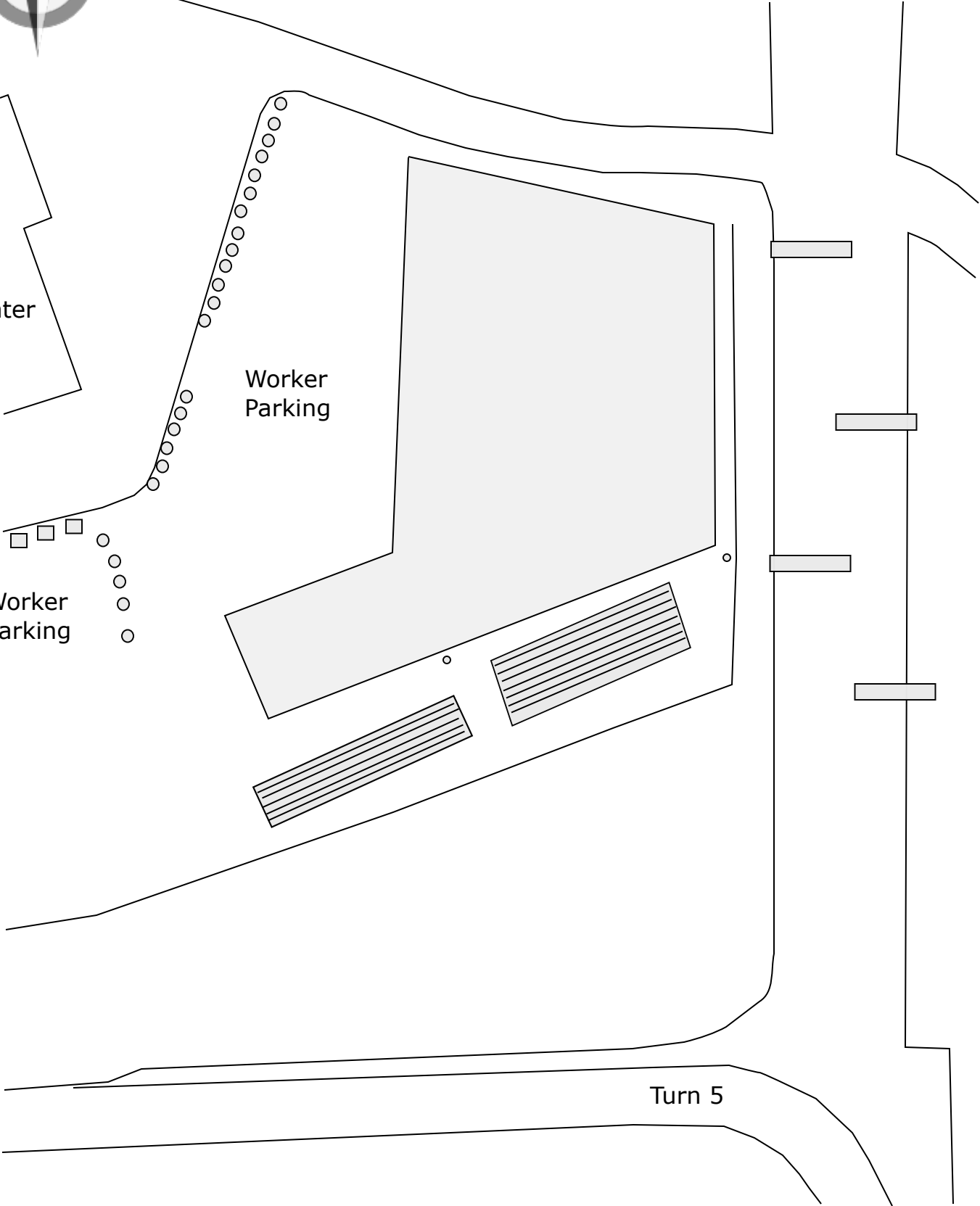

COMPETITION PADDOCK - ROWS 7-13

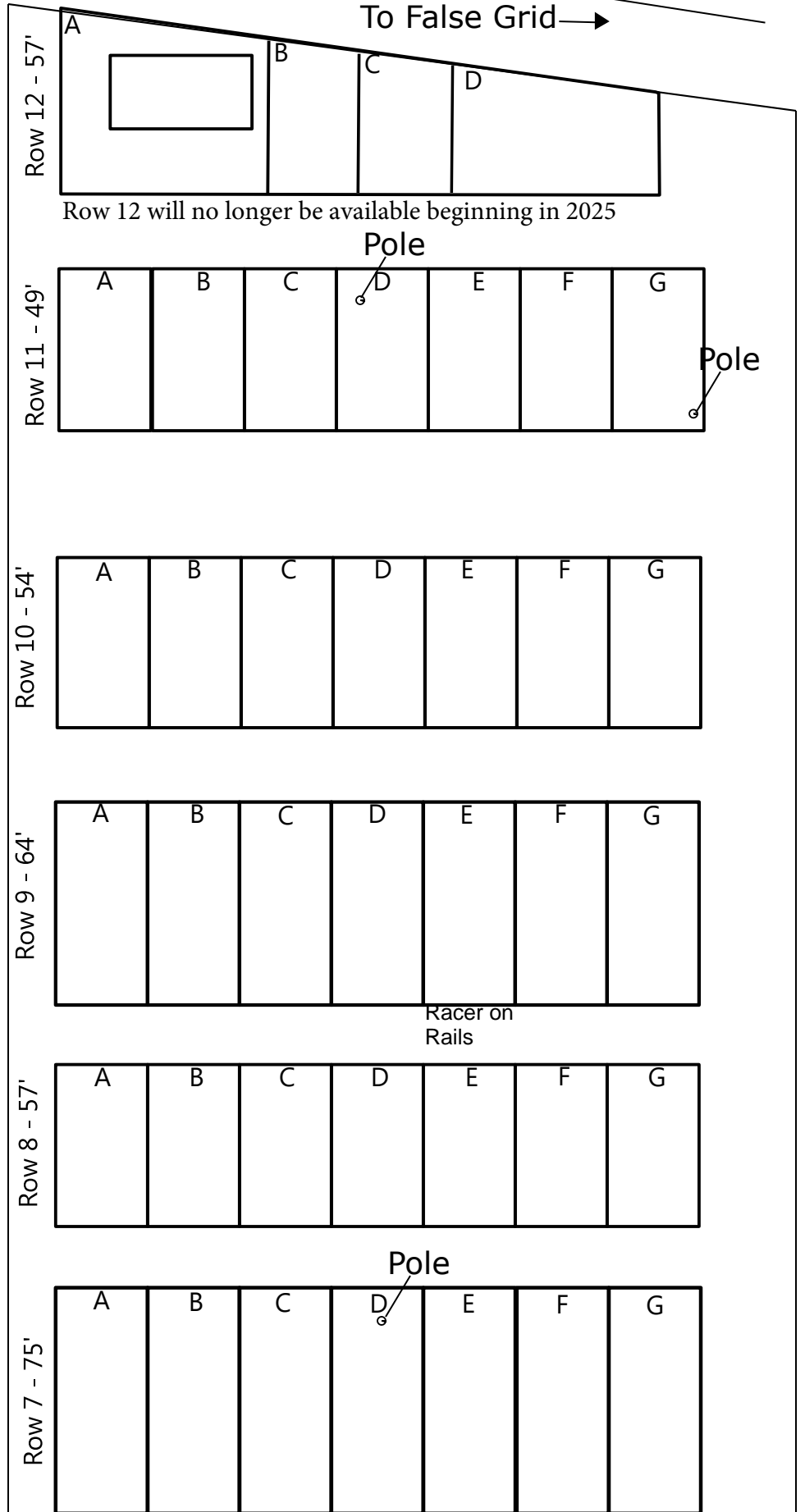
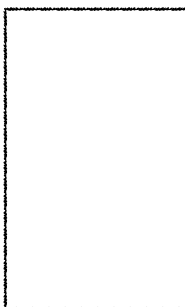
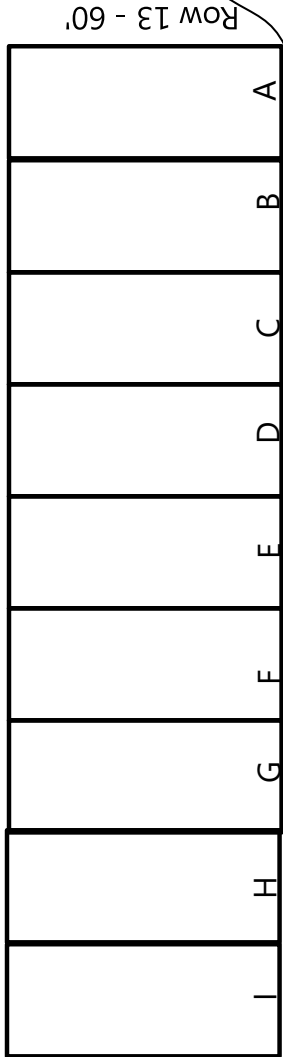

COMPETITION PADDOCK ROWS 1-6

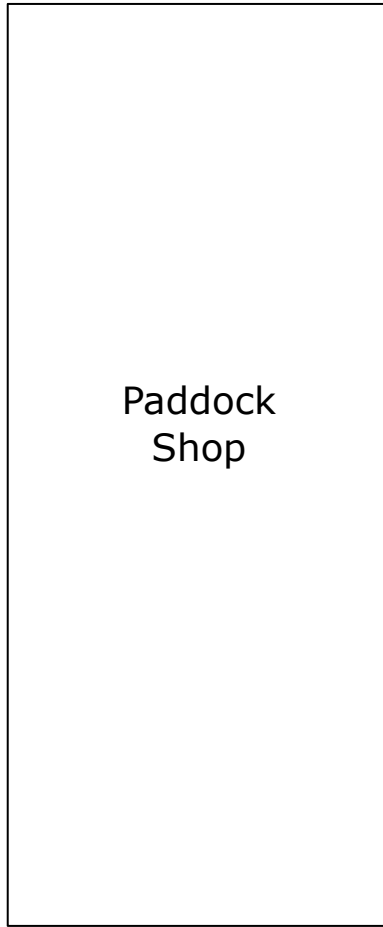

To Lower West & South Paddock

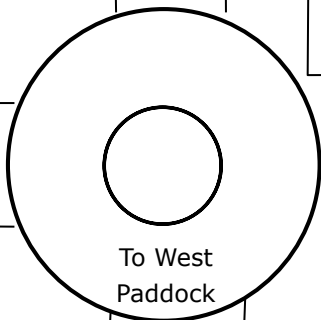

Row 6 - 87'

A	B	C	D	E	
Ground may be too soft this year if wet. Will use last minute if suitable. No pre-reserve.					
					Gas Station & Press Room

Row 5 - 54'

A	B	C	D	New Winner's Circle

PAVED Row 4 - 80'

A	B	C	D	New Winner's Circle
Not a space				

To Main Paddock

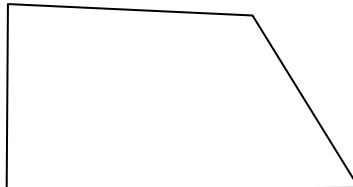
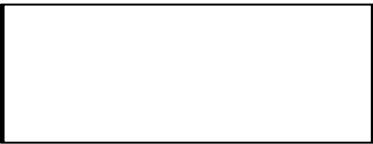

Paker John's BBQ

MAIN PAVED NORTH END

To Tunnel

Medical

Restrooms /
Showers

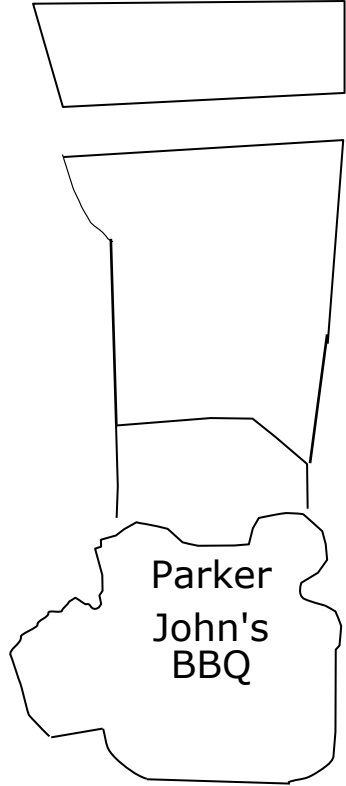
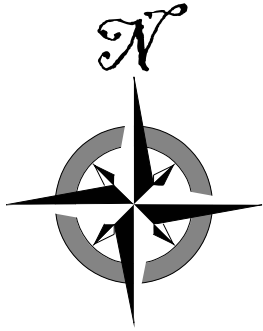

West
Paved
Paddock

# 1	
# 2	
# 3	
# 4	
# 5	
# 6	
# 7	
# 8	
# 9	
# 10	
# 11	
# 12	
# 13	
# 14	
# 15	
# 16	
# 17	
# 18	
# 19	
# 20	
# 21	
# 22	
# 23	
# 24	
# 25	

Drive

MAIN PAVED PADDOCK - SOUTH END

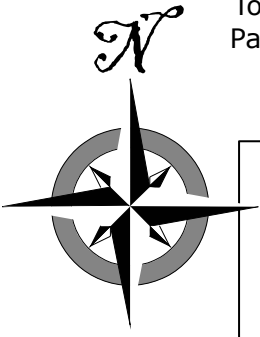

To West Paddock

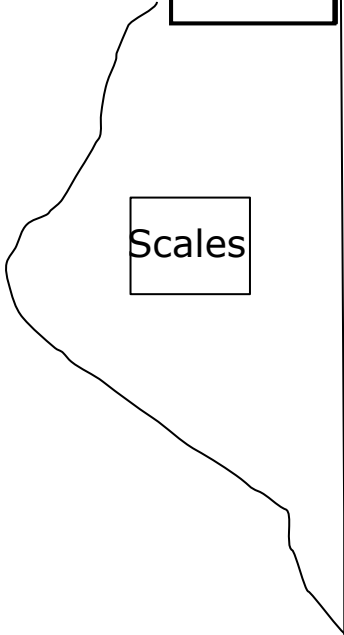

Scales

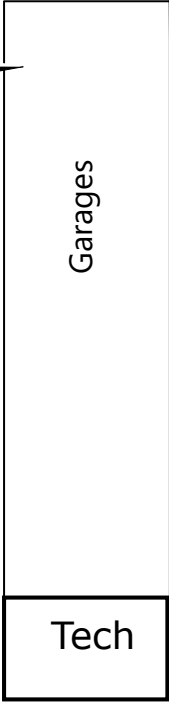

Tech

Garages

#39	#38	#37	#36	#35	#34	G1	G2	G3	G4	G5	G6	G7	G8	G9	G10	G11	G12	G13	#26	Team
IMPOUND																				

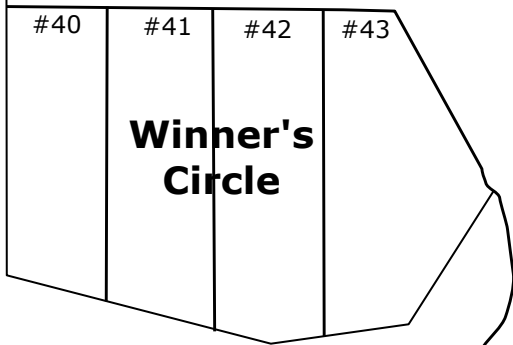

Winner's Circle

#40

#41

#42

#43

To Upper Paved

Pit Lane

Main Straight

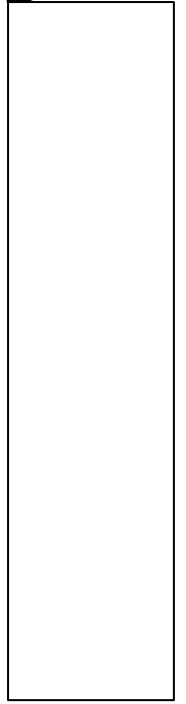

West Paved (Reserved)



Medical

West

To South Paddock & Sargento Bridge

#86	#85	#84	#83	#82	#81	#80
-----	-----	-----	-----	-----	-----	-----

#70	#71	#72	#73	#74	#75	#76	#77	#78	#79
-----	-----	-----	-----	-----	-----	-----	-----	-----	-----

#69	#68	#67	#66	#65	#64	#63	#62	#61	#60	#59	#58
-----	-----	-----	-----	-----	-----	-----	-----	-----	-----	-----	-----

Parker John's
BBQ & Wings

#45*	#46*	#47*	#48	#49	#50	#51	#52	#53	#54	#55	#56	#57
------	------	------	-----	-----	-----	-----	-----	-----	-----	-----	-----	-----

West Paddock (Reserved)



Medical

No tow rigs within first 10' from road
#1 #2 #3 #4 #5 #6
#7 #8
No tow rigs within first 10' from road
#9 #10 #11 #12 #13

To South Paddock & Sargento Bridge

West
Paved

UPPER PAVED PADDOCK



Tire Companies

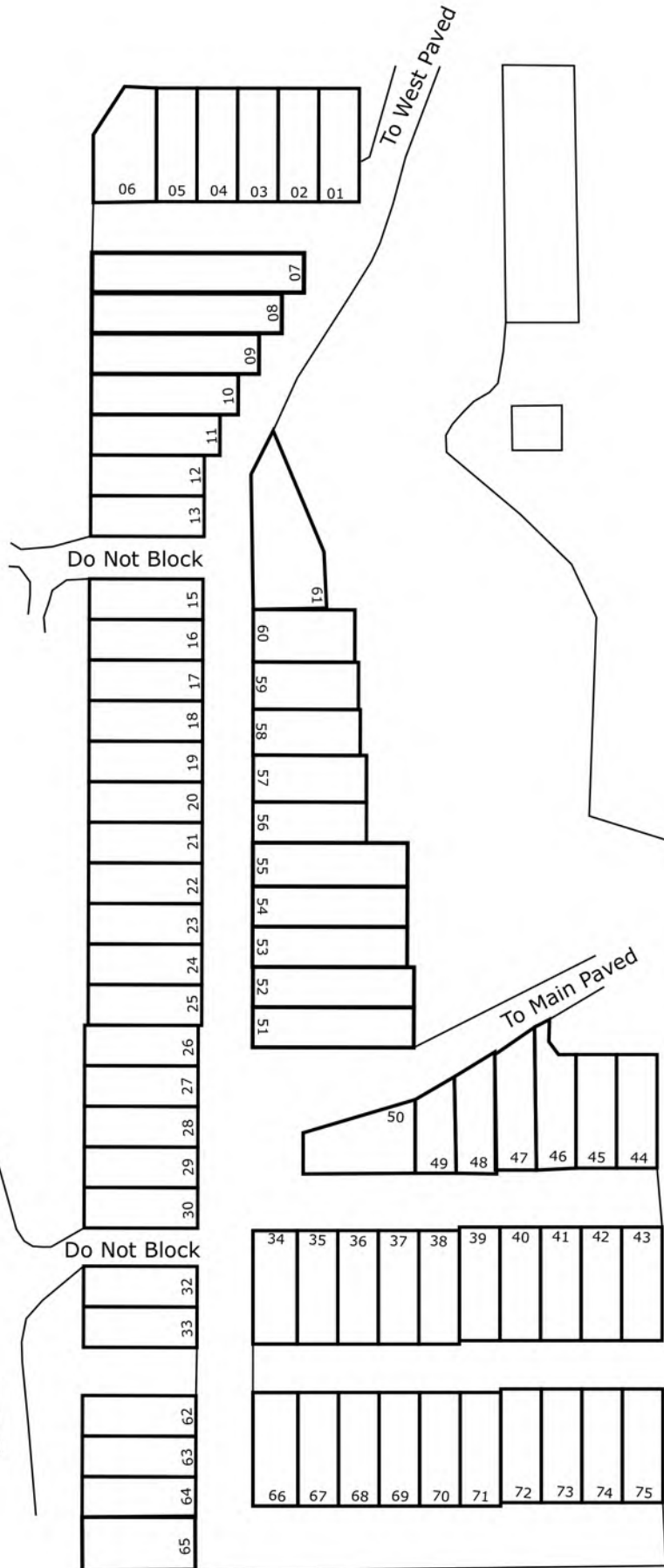

UPPER PAVED PADDOCK (North)

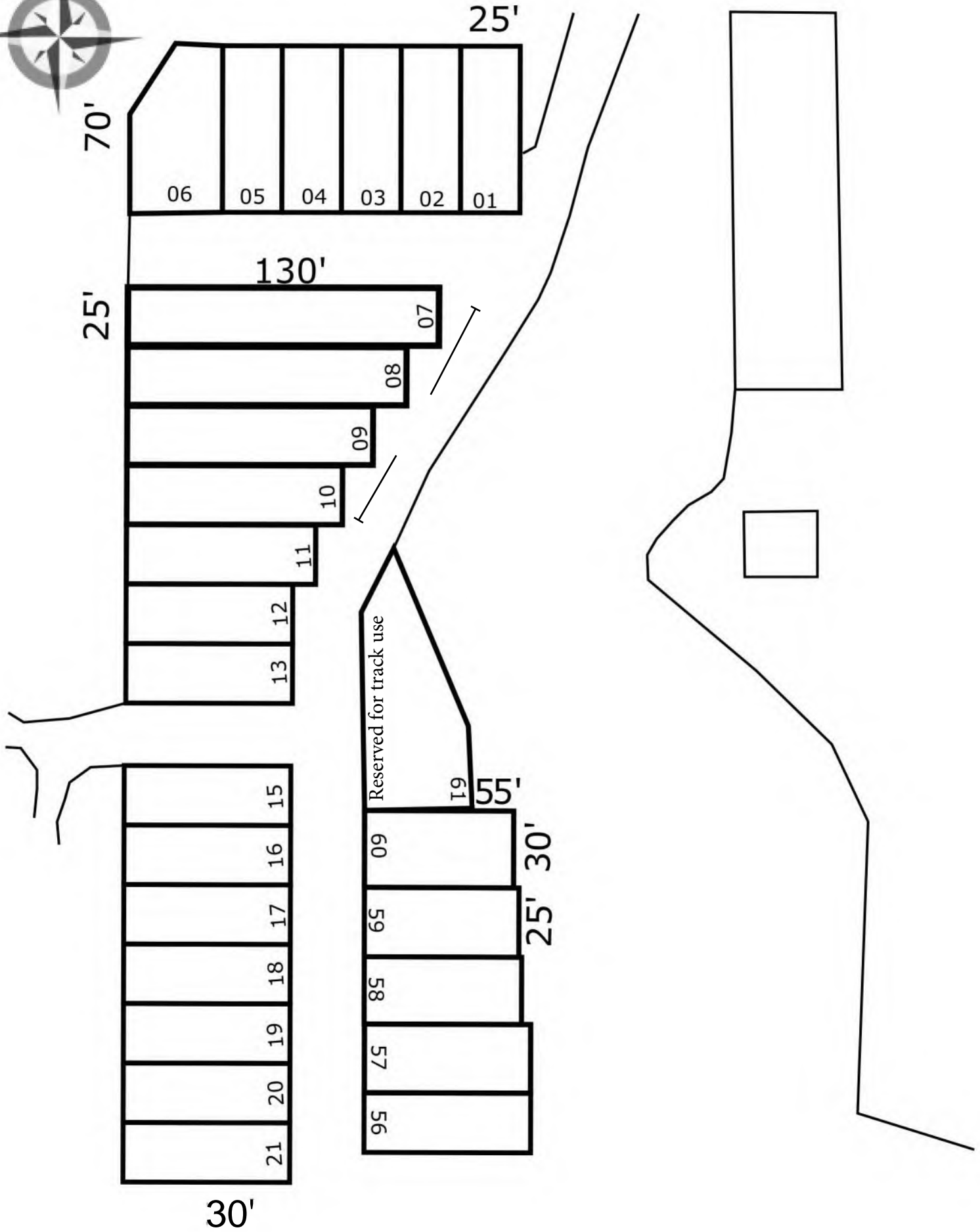

UPPER PAVED PADDOCK (South)

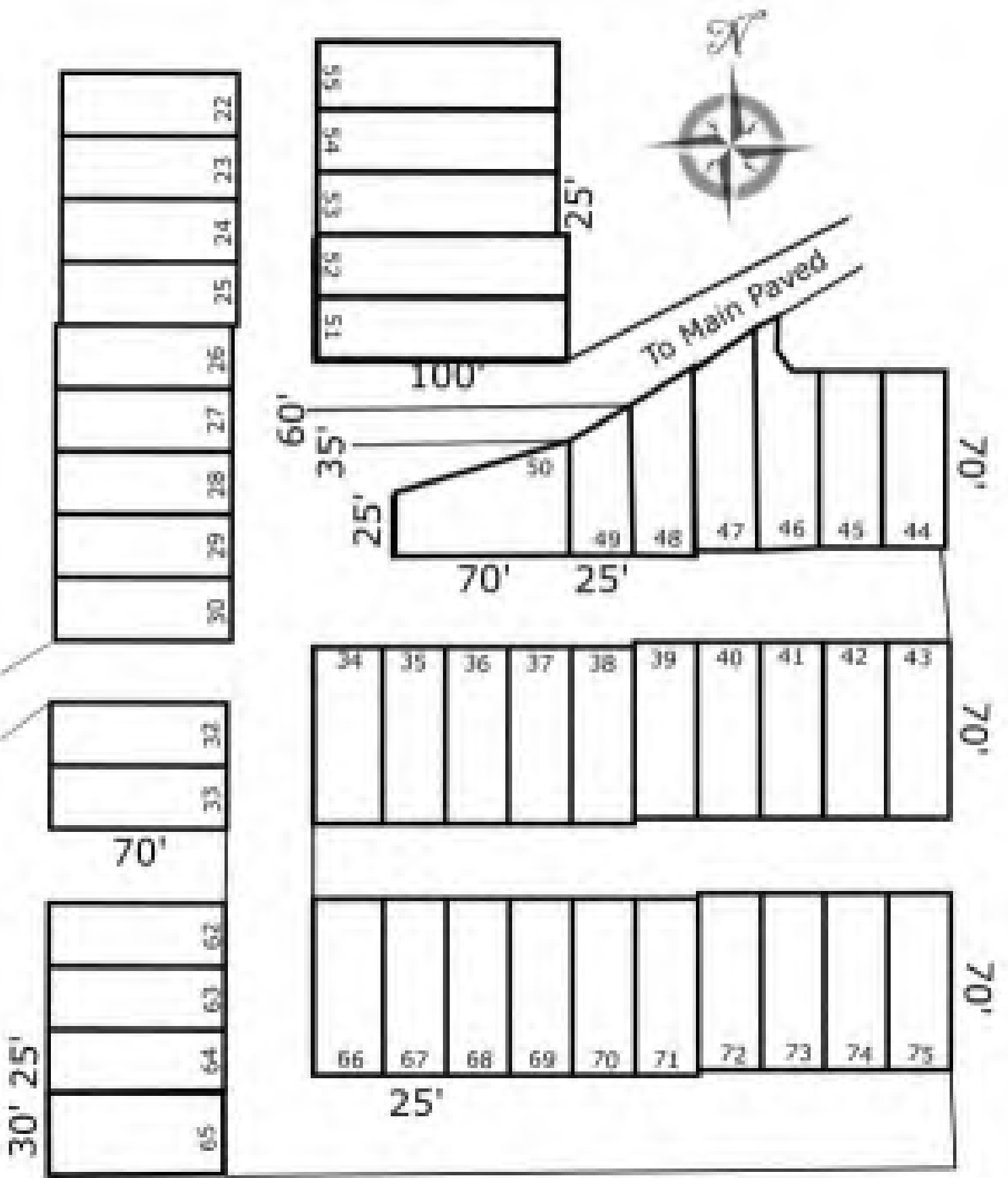

South (Unreserved)

